

## WHAT TO DO WHEN VISITING

- Stroll our historic grounds and display gardens.
- Experience the Daffodil Bowl, filled with thousands of blooms throughout April.
- Take a walk on our woodland trails.
- View art exhibits in Wisner House Gallery and on the grounds.
- Enjoy our summer concert series, *Sounds of a Summer Night*.
- Enjoy spectacular fall foliage as well as the perennial border's final performance of autumn blooms.
- Explore the past in our Historic Exhibit.
- Borrow a backpack on Discovery Weekends and investigate the flora and fauna of RRA!

Check out our website or our Visitors Center on-site to find out about current events and programs!

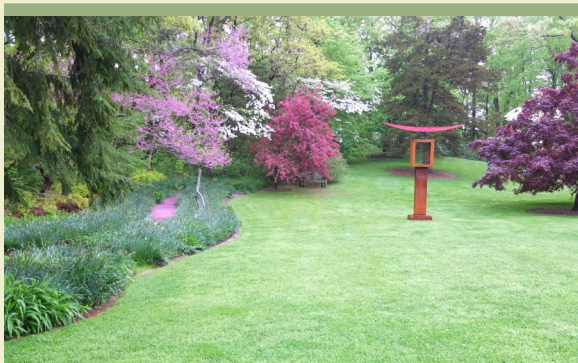

## HISTORY

Originally a country estate built in 1889, three families consecutively owned *The Clearing*. Reeves-Reed Arboretum was founded in 1974 with the aid of local citizens, who raised most of the cost to preserve the estate as an arboretum.

The Wisner family (1889-1916) commissioned Calvert Vaux, partner in the creation of Central Park's sweeping "greensward" look, to develop an overall landscape plan.

The Reeves family (1916-1968) commissioned landscape architect Ellen Biddle Shipman in 1924 for a concept design, which was largely implemented by Carl F. Pilat in 1924-1925 and included garden rooms such as the Rose and Azalea Gardens.

The last private owners, the Reed family (1968-1973), contributed the Herb Garden and creation of the Woodland Trails.

Today, Reeves-Reed Arboretum is listed on the National and State Registers of Historic Places.

Annually, over 100,000 visitors come to enjoy the beauty and serenity of this 13.5 acre historic estate.

## MISSION STATEMENT

Reeves-Reed Arboretum engages, educates, and enriches its visitors so they become better stewards of nature and the environment. This mission is achieved through the care and utilization of an historic estate and gardens.

*Not a member?  
Join today!*



Reeves-Reed Arboretum  
165 Hobart Avenue  
Summit, NJ 07901  
(908) 273-8787  
[reeves-reedarboretum.org](http://reeves-reedarboretum.org)

Questions?  
Email [info@reeves-reedarboretum.org](mailto:info@reeves-reedarboretum.org)

## GARDEN ETIQUETTE

Help preserve the Arboretum's tranquil setting and maintain its historic and beautiful collections and native habitats by following these points of garden etiquette:

- Group picnics & alcohol need prior RRA approval
- Artwork and sculptures must not be touched
- Refrain from smoking
- Don't pick flowers or vegetation
- Eliminate trash from the grounds - carry it out
- No pets allowed

- Experience with respect
- Trees should not be climbed, sat in, or pulled
- Inquire about photography permits
- Quiet enjoyment is appreciated
- Utilize only paths, trails and grass for walking
- Enjoy water features from the lawn or patio
- Thwart attempts to bike ride or play sports
- Taboo to enter flower beds, shrub borders & wild areas
- Escort children under 12 at all times

**GROUND'S ARE OPEN 7 DAYS A WEEK**  
April-October 7am-7pm, November-March 9am-4pm

## ACCESSIBILITY PROJECT

While we strive to make the Arboretum accessible to all, the "Core Grounds" of RRA are still a work in progress. The Accessibility Project, begun in 2017, has one more phase to go in completing the closing of the loop from the Amphitheater to the Greenhouse. Help make this possible by donating today!



# MAP & GUIDE

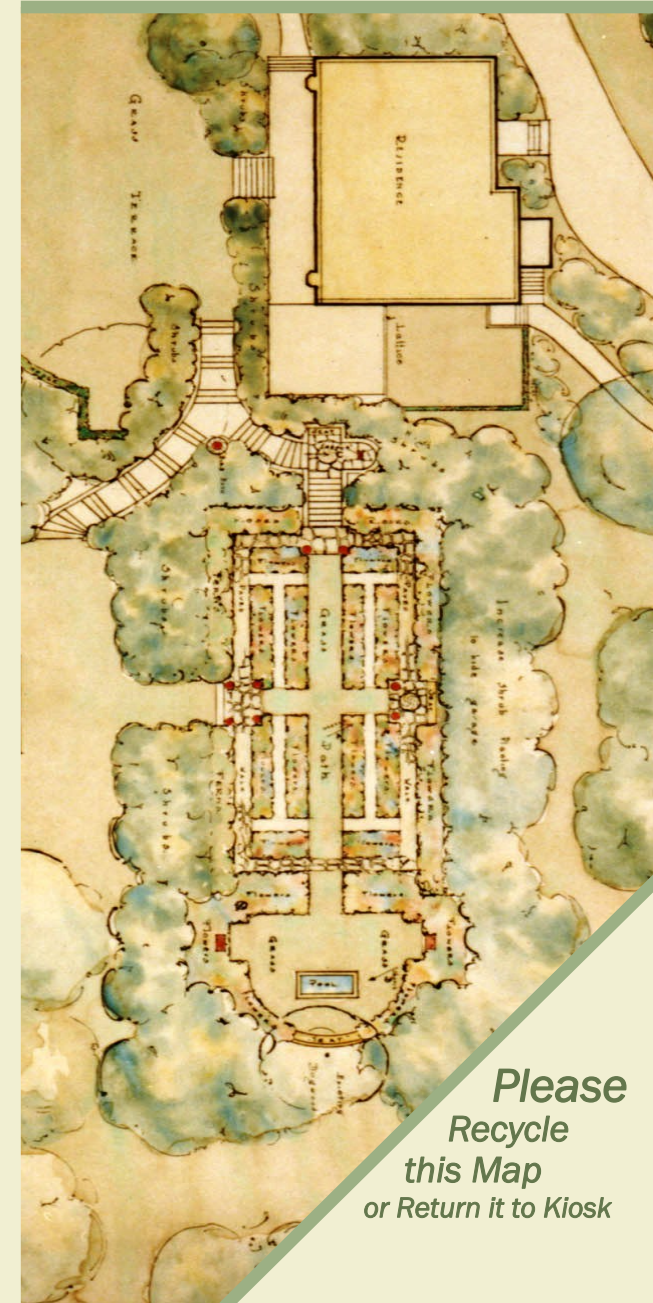

*Please  
Recycle  
this Map  
or Return it to Kiosk*



# SELF-GUIDED TOUR

- Restroom
- Water Fountain
- Handicapped Accessible Restroom
- Handicapped Accessible Path
- Handicapped Parking
- Baby-changing station

**1. VISITORS CENTER** Start your visit here to find out what's happening at the Arboretum! Phase I of our Accessibility Project.

**2. WELCOME WALK** A mixed border of perennials, annuals, and tropical plants, this walk also contains part of the Montine McDaniel Freeman Medal collection, which is distinguished with green labels. See *Freeman Medal* brochure for more details.

**3. WISNER HOUSE GALLERY & HISTORIC EXHIBIT** Built in 1889, the first floor houses seasonal art exhibits and is available for event rentals. On the sub-level, enjoy RRA's year-round historic exhibit.

**4. WESSON NATURE GROVE & ELEPHANT TREE** This European beech tree was planted over a century ago and was given its nickname by children attending RRA's summer camp. An amphitheater of stone creates a favorite outdoor classroom.

**5. PETER'S POND & BOG GARDEN** Native New Jersey carnivorous plants live in the bog garden. The pond is a favorite spot for children and migrating birds.

**6. PERENNIAL BORDER** This serpentine, tiered garden blooms from April to October.

**7. DAFFODIL BOWL** First planted with daffodils by Susie Graham Reeves in the 1920s, it now contains tens of thousands of daffodils blooming in April. From May to November, wildflowers bloom, supporting native New Jersey wildlife from butterflies to birds, foxes and groundhogs.

**8. PRIMROSE PATH** Many species and cultivars of primroses bloom amidst forget-me-nots in the spring, Colchicum in the fall.

**9. SUGAR MAPLE** In late winter, this Arboretum favorite is tapped to make syrup from its sap. In October, the canopy turns glorious shades of orange and yellow.

**10. CHO AMPHITHEATRE** This space is ideal for classes, concerts, and ceremonies and is Phase II of our Accessibility Project.

**11. HERB GARDEN** This 1960s garden, developed by Charles and Ann Reed and maintained by the Summit Garden Club, is planted with medicinal and culinary perennials.

**12. SUSIE GRAHAM REEVES ROSE GARDEN** This 1925 garden offers dozens of varietal roses blooming in June, with another flush in the fall.

**13. RICHARD, GRAHAM, AND SUSAN REEVES ROCK GARDEN** A quiet and peaceful garden room from the 1920s named for the three Reeves children.

**14. GRETCHEN KELLER AZALEA GARDEN** This 1920s garden is the embodiment of a "garden room" and blooms abundantly with azaleas, deutzia, rhododendrons, hydrangeas, crabapples, and lilacs.

**15. LOUISE MUNCIE ROEHM GREENHOUSE** Dedicated in 1997, the greenhouse is used as a classroom and for the propagation of plants to be sold at the spring Plant Sale, and used on the Arboretum grounds.

**16. TIME CAPSULE GARDEN** This garden will include only plants that would have been available to gardeners in the designated year.

**17. STACKHOUSE EDUCATION CENTER & CHILDRENS GARDEN** A re-designed carriage house, the Stackhouse Education Center is now the hub of RRA's Children's Education programs. The vegetable garden is planted in the style of Square Foot Gardening.

**18. IRENE REICH WILDFLOWER TRAIL** Spring ephemerals bloom March through May along this winding woodland trail.

**19. SIGNAL FIRE #10 REPLICA** An 18th-century farmer used a nearby property as a signal beacon to warn General Washington of the movement of the British against his encampment in Morristown. Daughter's of the American Revolution have a plaque to commemorate the site.

**20. WOODLAND TRAILS** The Arboretum features over six acres of woodlands and nearly one mile of hiking trails that are blazed for orientation. See *Healthy Hike* brochure for more details.

## WOODLAND TRAIL DISTANCES

- .15 miles
- .08 miles
- .20 miles
- .10 miles
- .16 miles